

TYPE "HMO" - "HMOLM"

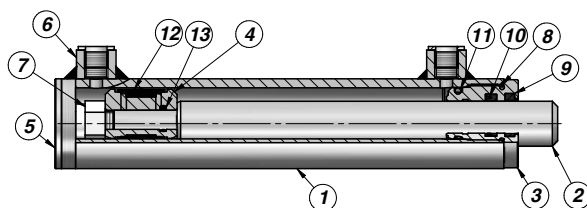

"HMO" Pressione Massima - Max. Pressure - Max. Druck: 210 Bar
"HMOLM" Pressione Massima - Max. Pressure - Max. Druck: 180 Bar

TYPE "HFR2S"

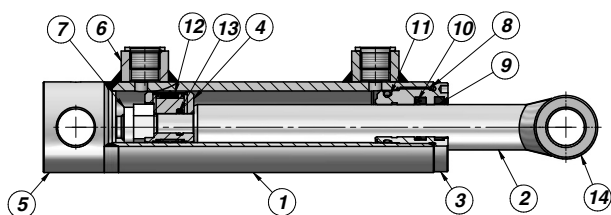

"HFR2S" Pressione Massima - Max. Pressure - Max. Druck: 210 Bar

TYPE "HMF"

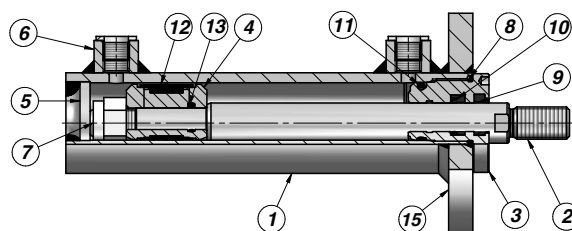

"HMF" Pressione Massima - Max. Pressure - Max. Druck: 210 Bar

1	TUBO LUCIDO POLISHED TUBE - POLIERTES ZYLINDERROHR	ACCIAIO - STEEL - STAHL: St 52.3 DIN 2393 ISO H9
2	STELO CROMATO CHROMED ROD - VERCHROMTE KOLBENSTANGE	ACCIAIO - STEEL - STAHL: UNI C45 - SAE 1045 CROMO - CHROME - CHROM: 25 Micron ±5 Rating 9/120 h ISO 10289 - 1999/ISO 9227-NSS
3	TESTATA DI GUIDA HEAD-BUSH - KOLBENSTANGENFÜHRUNG	GHISA - HYDRAULIC CAST IRON - HYDRAULIKGUSS: UNI 5007-G25
4	PISTONE - PISTON - KOLBEN	ACCIAIO - STEEL - STAHL: 9SMn28
5	FONDELLO - END-PLUG - ZYLINDERBODEN	ACCIAIO - STEEL - STAHL: S355J0 (Fe510C) - S355JR (A105)
6	BORCHIA FILETTATA THREADED PORT - ANSCHLUSSGEWINDE	ACCIAIO - STEEL - STAHL: 9SMn28
7	DADO AUTOBLOCCANTE LOCKNUT - SELBSTSPERRENDE MUTTER	ACCIAIO - STEEL - STAHL: UNI 7473 - 7474
8	GUARNIZIONE - SEAL - DICHUNG O-RING	NBR 70 SHORE
9	GUARNIZIONE - SEAL - DICHUNG "GHK"	POLIURETANO - POLYURETHANE - POLYURETHAN
10	GUARNIZIONE - SEAL - DICHUNG "TSE-TTS-TTI/L"	"TSE": NBR+TESSUTO - NBR+FABRIC - NBR+GEWEBE "TTS-TTI/L": POLIURETANO - POLYURETHANE - POLYURETHAN
11	GUARNIZIONE - SEAL - DICHUNG O-RING	NBR 70 SHORE
12	GUARNIZIONE - SEAL - DICHUNG "TPM"	NBR+POM+POLIESTERE - NBR+POM+POLYESTER
13	GUARNIZIONE - SEAL - DICHUNG O-RING	NBR 70 SHORE
14	BOCCOLA - BUSH - BUCHSE	ACCIAIO - STEEL - STAHL: S355J0 (Fe510C)
15	FLANGIA - FLANGE - FLANSCH	ACCIAIO - STEEL - STAHL: S355J0 (Fe510C)

Velocità Limite - Top Speed - Höchstgeschwindigkeit: max 0,5 m/s
Temperatura C° - Temperature C° - Temperaturbereich C°: -25°C - +80°C

TYPE "HTO"

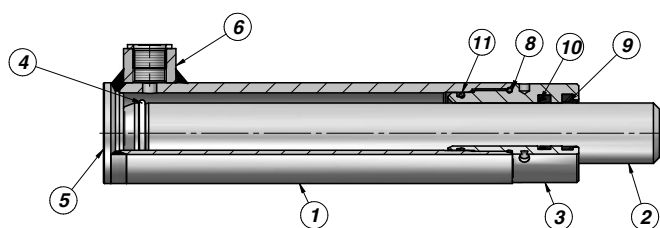

"HTO" Pressione Massima - Max. Pressure - Max. Druck: 210 Bar

TYPE "HFRT"

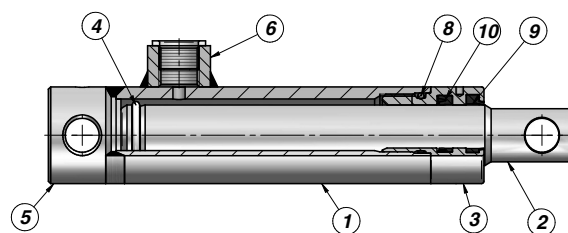

"HFRT" Pressione Massima - Max. Pressure - Max. Druck: 210 Bar

1	TUBO LUCIDO POLISHED TUBE - POLIERTES ZYLINDERROHR	ACCIAIO - STEEL - STAHL: St 52.3 DIN 2393 ISO H9
2	STELO CROMATO CHROMED ROD - VERCHROMTE KOLBENSTANGE	ACCIAIO - STEEL - STAHL: UNI C45 - SAE 1045 CROMO - CHROME - CHROM: 25 Micron ±5 Rating 9/120 h ISO 10289 - 1999/ISO 9227-NSS
3	TESTATA DI GUIDA HEAD-BUSH - KOLBENSTANGENFÜHRUNG TIPO - TYPE - TYP: "HTO"	GHISA - HYDRAULIC CAST IRON - HYDRAULIKGUSS: UNI 5007-G25
3	TESTATA DI GUIDA HEAD-BUSH - KOLBENSTANGENFÜHRUNG TIPO - TYPE - TYP: "HFRT"	ACCIAIO 9SMn28 CON TRATTAMENTO "NI-TEMPER" STEEL 9SMn28 WITH "NI-TEMPER" TREATMENT STAHL 9SMn28 MIT "NI-TEMPER-BEHANDLUNG"
4	ANELLO DI ARRESTO - STOP RING - KLEMMRING	ACCIAIO - STEEL - STAHL
5	FONDELLO - END-PLUG - ZYLINDERBODEN	ACCIAIO - STEEL - STAHL: S355J0 (Fe510C) - S355JR (A105)
6	BORCHIA FILETTATA THREADED PORT - ANSCHLUSSGEWINDE	ACCIAIO - STEEL - STAHL: 9SMn28
8	GUARNIZIONE - SEAL - DICHTUNG TIPO - TYPE - TYP: "HTO" O-RING	NBR 70 SHORE
8	GUARNIZIONE - SEAL - DICHTUNG TIPO - TYPE - TYP: "HFRT" O-RING	NBR 90 SHORE
9	GUARNIZIONE - SEAL - DICHTUNG "GHK"	POLIURETANO - POLYURETHANE - POLYURETHAN
10	GUARNIZIONE - SEAL - DICHTUNG "TSE-TTS-TTIL"	"TSE": NBR+TESSUTO - NBR+FABRIC - NBR+GEWEBE "TTS-TTIL": POLIURETANO - POLYURETHANE - POLYURETHAN
11	GUARNIZIONE - SEAL - DICHTUNG O-RING	NBR 70 SHORE

Velocità Limite - Top Speed - Höchstgeschwindigkeit: max 0,5 m/s
Temperatura C° - Temperature C° - Temperaturbereich C°: -25°C - +80°C